

Instruction & Assembly

Stainless Steel Removable Handle for F-Series hand pump kits

UNDERSTAND THOROUGHLY PRIOR TO INSTALLATION

Your Removable Stainless Steel Handle comes with a threaded PVC adapter pre-installed from the factory. This PVC adapter attaches to your pump shaft for easy handle removal. You will attach the PVC adapter to the 3/4" pump rod as shown in illustration (A), using standard PVC cleaner, primer and glue.

If your pump is new, you may choose to install the ball valve (included with your pump) or not.

If you plan to use the ball-valve for pressurizing your home plumbing system, glue it to the pump first, and then install the stainless handle above the ball valve as show in illustration (B). Sacrifice the unused 3/4" PVC handle parts as needed.

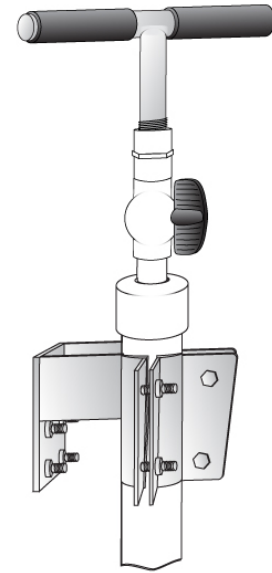
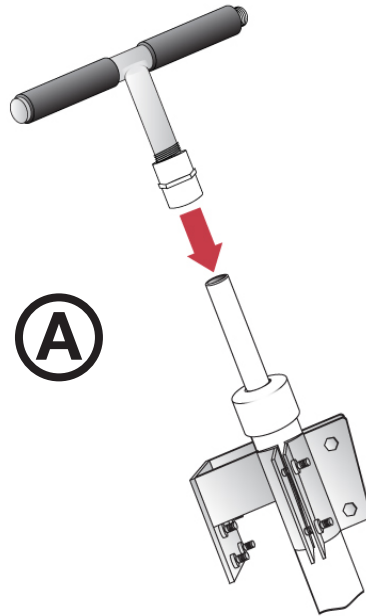

Attaching the stainless steel removable handle is easily done as the new pump is being assembled. If your FloJak is already installed, lift the PVC handle a foot or so, and cut it off under the ball valve.

Caution--Be very careful NOT to drop the pump shaft into the pump. Retrieval is difficult. As a precaution, lift the handle and tape a cross piece of pipe to the 3/4" shaft to keep it from dropping as you work.

Now you may simply glue the PVC coupler attached to stainless handle into place.

Very Important--Allow it to cure for 24 hours before pumping.

To remove the handle after pumping, grip the PVC fitting and simply twist the handle. Then install a threaded plug to keep debris from entering the pump.